

Unpacking

Before you start using the device, please check the product version, and ensure that the following items are included in the shipped box:



IT88X x 1



Flush-mounting bracket x 1

Diode x 2



M3x6 headless screw x 1



10-Pin cable x 1



11-Pin cable x 1

M4x20 crosshead screw x 4



Allen wrench x 1

Product Overview

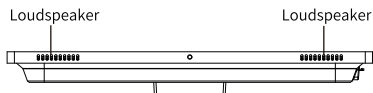
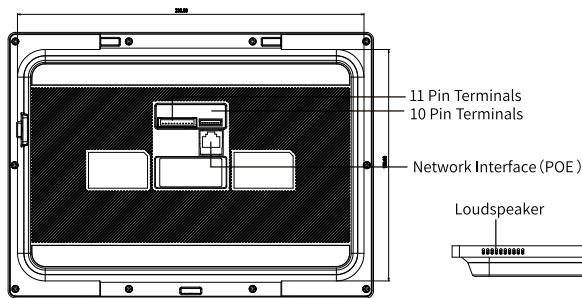
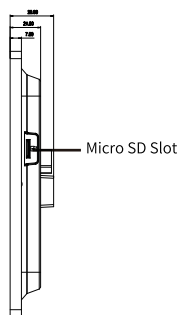
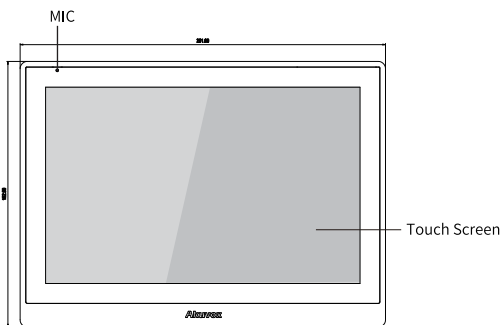

Installation

Step 1: Flush-mounting Box Installation

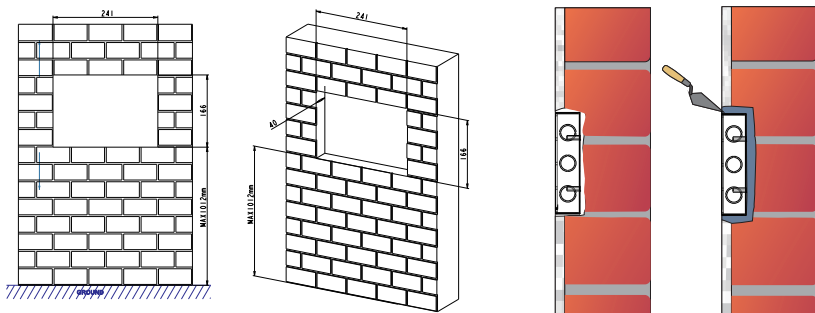

Mark where the box will be located, and cut out a rectangular hole (height*width*depth=166*241*40mm) in the wall. Fit the flush-mounting box into the hole, and run cables through it.

Note: The maximum height from the ground to the hole's bottom edge is 1012 mm.

Fill the gap between the wall and flush-mounting box with cement or non-corrosive structural adhesive. The adhesive must dry before you continue to the next step.

Step 2: Flush-mounting Bracket Installation

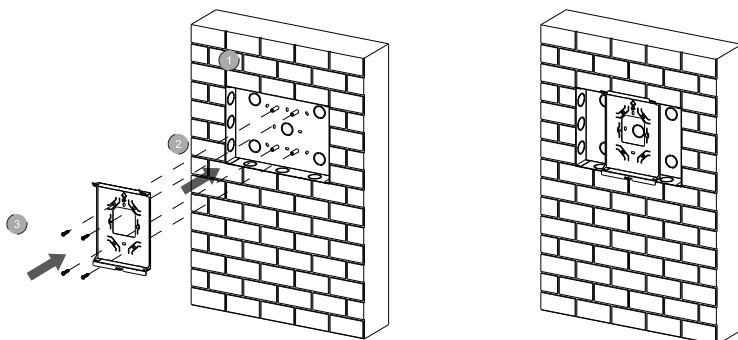

Make sure the cables go through the hole of flush-mounting bracket. Fasten the bracket to the box using four M4x20 crosshead screws.

The flush-mounting bracket installation is done.

IT88X Flush-mounting Installation Quick Guide

Step 3: Device Installation

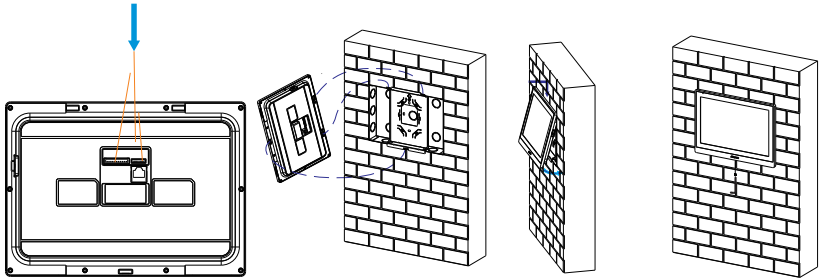

Connect cables to the corresponding ports on the back of IT88X (please refer to the Device Wiring section).

Rotate the device at 15° as the figure shown. Align the two upper holes on the back cover with the hooks of bracket. Press the device into the bracket until it is clipped on.
Note: Make sure the screw holes at the bottom of the device align to the bracket's.

Use Allen wrench to tighten the M3x6 headless screw at the bottom of the device. Device installation is done.

Device Wiring

⚠ Warning

When you connect a device containing a coil, such as a relay or an electromagnetic lock, it is necessary to protect the intercom against voltage peak while switching off the induction load. For this way of protection we recommend a diode 1 A / 200 V (included in the accessories) connected antiparallel to the device.

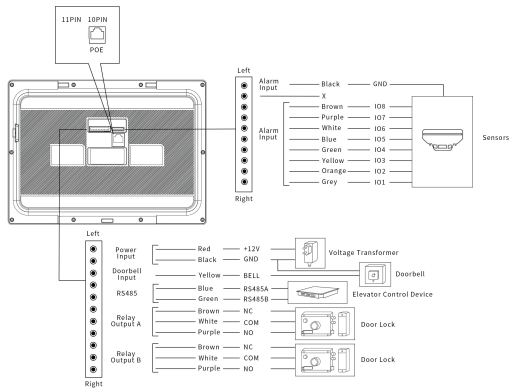
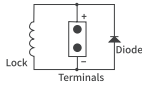

Device Removal



Before removing the device from the bracket, remove M3x6 headless screw at the bottom.

Application Network Topology

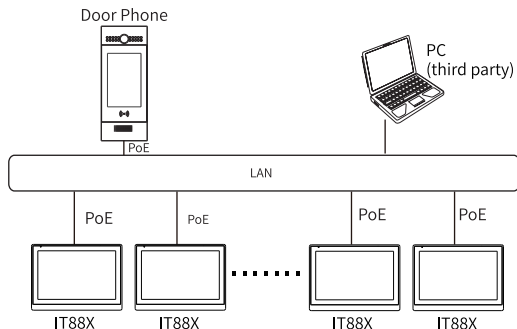

Configuration



1. Access basic information: After setting up network and power, go to **Setting > System Info** to check Account and Network status, and Version info.
2. Access the Website: Type the IP address of the device into the browser, then enter the username and password to login (user name/password: admin/admin by default).
3. Account Registration: On web interface, go to **Account > Basic** to fill in the account information, and click **Submit** to confirm (**Please refer to user manual for more information**).

Operation

Make a call:

Enter the called' s number or room address, then press **Dial**  icon to make an audio call, or press **Video**  icon to make a video call. Press  icon to hang up.

Receive a call:

Press  icon to pick up an incoming video call or press  icon to pick up an audio call.

Unlock:

During a call, you can press **Unlock**  icon on the talking interface to unlock the door.

Monitor:

Press **Monitor**  icon to see the video stream from the door phone or from third-party devices.

Notice Information



Information contained in this document is believed to be accurate and reliable at the time of printing. This document is subject to change without notice, any update to this document can be viewed on Akuvox' s website: <http://www.akuvox.com> © Copyright 2022 Akuvox Ltd. All rights reserved.

AKUVOX (XIAMEN) NETWORKS CO., LTD.
Add.: 10/F, NO.56 GUANRI ROAD, SOFTWARE PARK II, XIAMEN 361009, CHINA
www.akuvox.com



YS8800004